

L系列  
高端精密伺服节能注塑机

**L SERIES**

HIGH PRECISION SERVO ENERGY-SAVING INJECTION MACHINE

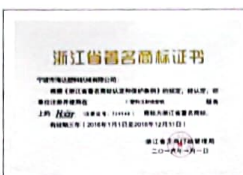





# L SERIES HIGH PRECISION SERVO ENERGY-SAVING INJECTION MACHINE TECHNICAL PARAMETER

## L系列高端精密伺服节能注塑机技术参数

机型 Model	单位 Unit	HD600L			HD680L			HD780L		
注射装置 Injection Unit										
螺杆直径 Screw Diameter	mm	80	85	90	90	95	100	100	105	110
螺杆长径比 Screw L/D Ratio	L/D	22.8	21.5	20.3	22.7	21.5	20.4	22.6	21.5	20.5
注射容积 Injection Volume	cm <sup>3</sup>	2212	2497	2799	2957	3294	3650	4006	4416	4847
注射重量 Shot Weight	g	2013	2272	2547	2691	3000	3322	3645	4019	4411
注射压力 Injection Pressure	Mpa	184	163	146	177	159	143	187	170	155
锁模装置 Clamping Unit										
合模力 Clamping Force	KN	6000			6800			7800		
模板行程 Opening Stroke	mm	900			940			980		
导柱内距 Space Between Tie—Bars	mm	880×880			940×920			980×960		
模具厚度 Mould Thickness(Min—Max)	mm	380—880			390—900			400—960		
顶出力 Hydraulic Ejection	KN	181			181			212		
顶出行程 Ejector Stroke	mm	240			260			270		
其它 General										
系统压力 System Pressure	Mpa	16			16			16		
电机功率 Motor Power	KW	60			37×2			45×2		
加热功率 Heater	KW	32.5			36			52		
外形尺寸 Machine Dimension	m	9.02×2.3×2.26			9.55×2.25×2.48			10.6×2.6×2.4		
机器重量 Machine Weight	t	24.9			28.5			37.8		
模具定位圈直径 Mold Location Recess Diameters	mm	Ø160			Ø200			Ø200		
喷嘴圆球半径 Nozzle Radius	mm	SR15			SR20			SR20		

■ 正常情况下改善技术规格参数，不予另行通知。  
Under Normal Circumstances Improve Technical Specifications, Shall Not Be Further Notice.



HD600L 模板图, 机器外型图

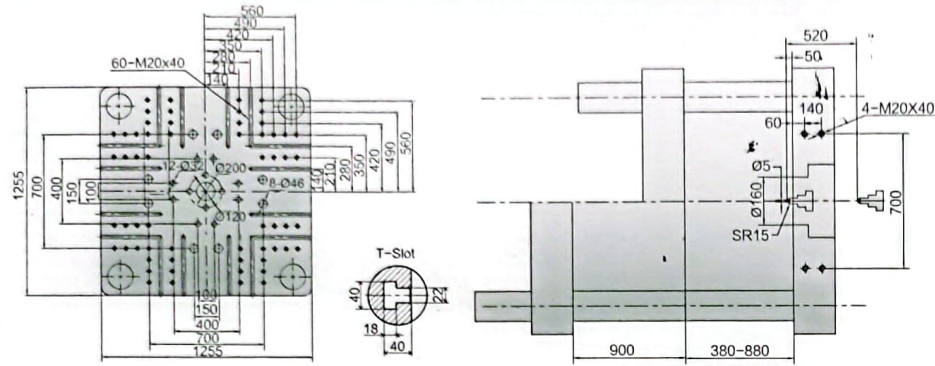

Platen Figure Machine Exterior Figure

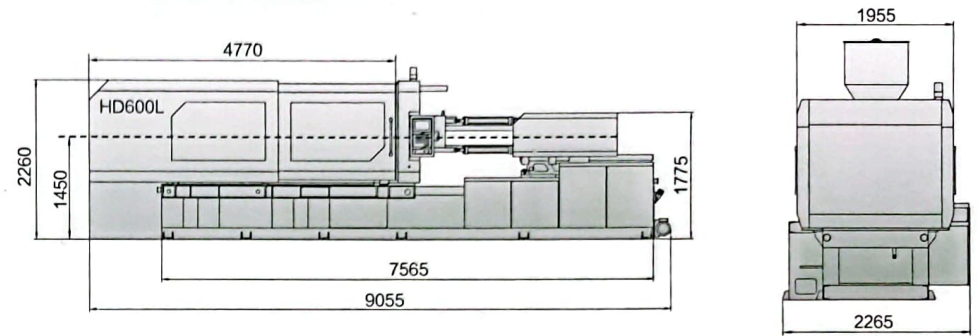

HD680L 模板图, 机器外型图

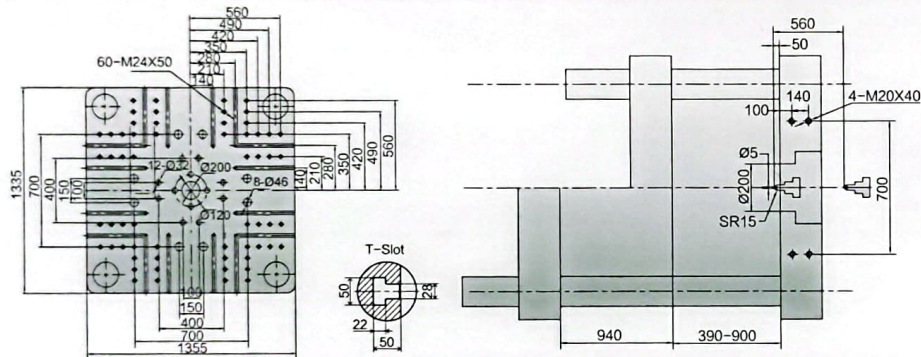

Platen Figure Machine Exterior Figure

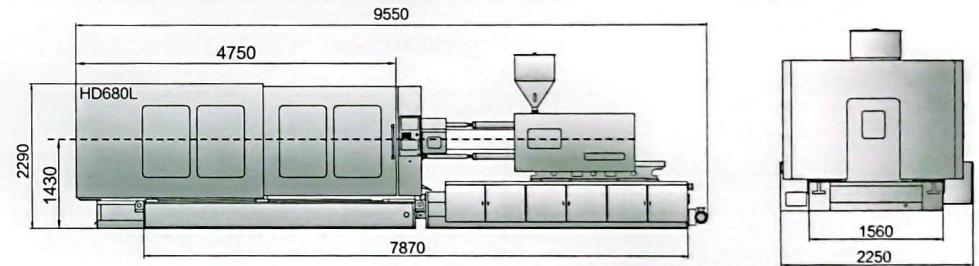

HD780L 模板图, 机器外型图

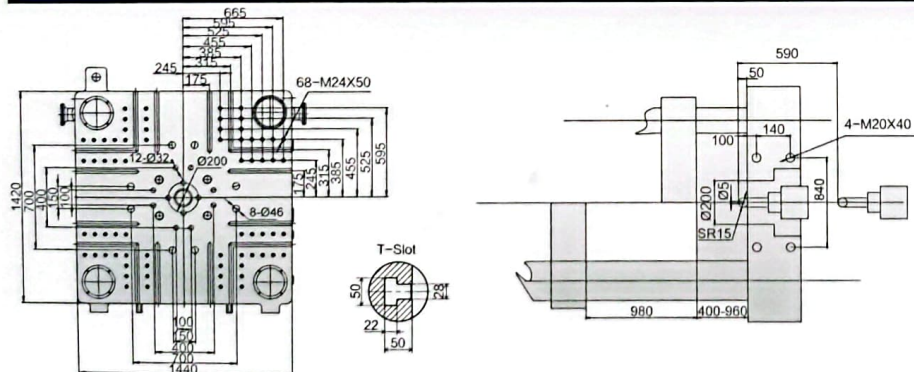

Platen Figure Machine Exterior Figure

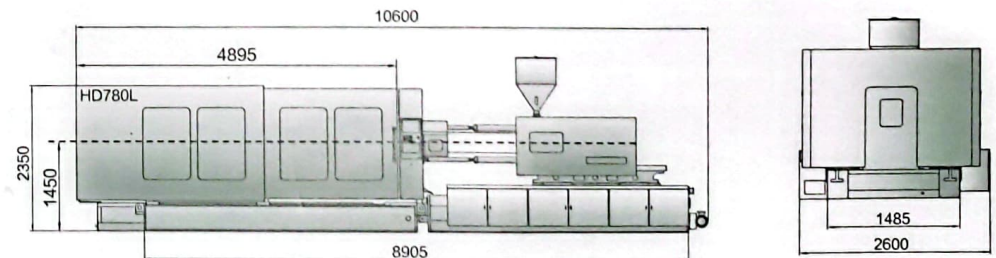

injection machine HS CODE:8477101090

Mold :8480719090

Auto Loader :8428200000

Air compressor :8414804990

Water Pump:8413709990

15:45